

MÉRETEK

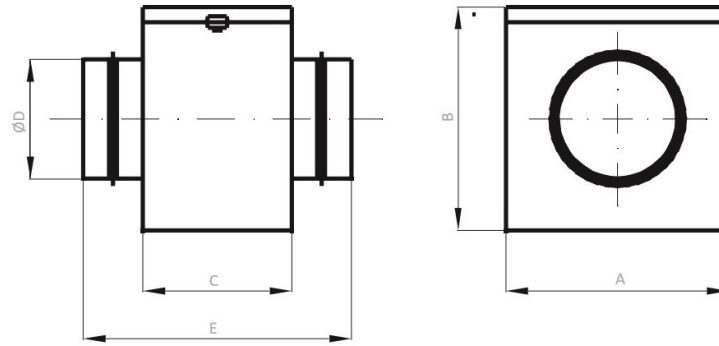

	$\varnothing D$ [mm]	A [mm]	B [mm]	C [mm]	D [mm]	Tömeg [kg]
FLK-B 100	100	208	167	120	168	2.10
FLK-B 125	125	218	202	140	188	2.10
FLK-B 150	150	268	232	155	203	2.30
FLK-B 160	160	268	232	155	203	2.30
FLK-B 200	200	318	271	180	228	3.50
FLK-B 250	250	365	319	230	278	3.50
FLK-B 315	315	428	387	330	378	6.10
FLK-B 355	355	518	492	455	583	8.40
FLK-B 400	400	518	492	455	583	8.40